

---

# **BRISTAN**

---

## **Installation Instructions and User Guide**

Bath Filler with Pop-Up Waste  
and Overflow

### **Models Covered:**

W BATH09 C

**Please keep this booklet for future  
reference.**

**Installer, when you have read these  
instructions please ensure you leave  
them with the user.**

# Introduction

Thank you for choosing Bristan, the UK's leading taps and showers expert. We have designed this product with your enjoyment in mind. To ensure that it works to its full potential, it needs to be fitted correctly. These fitting instructions have been created to give you all of the information you need and, if you need any further help, please do not hesitate to give us a call on 0330 026 6273.

# Specification

All products manufactured and supplied by Bristan are safe to use provided that they are installed, operated and receive regular maintenance in accordance with these instructions.

This product needs to be installed in accordance with, and meet the requirements of the Water Supply (Water Fittings) Regulations 1999 and current by-laws. For full Installation Requirements & Notes (IRN) please visit [wras.co.uk/directory](http://wras.co.uk/directory).

Isolation valves must be fitted to the inlet water supplies to ensure ease of future maintenance.

Before installing this product the water supply must be thoroughly flushed in order to remove any swarf, solder etc. Full access must be made available for future maintenance/servicing purposes.

This product must not be modified in any way as this will invalidate the guarantee.

If in doubt, contact a registered plumber, your Local Water Authority or the Secretary of the Institute of Plumbing, address as follows:-

The Institute of Plumbing,  
64 Station Lane,  
Hornchurch,  
Essex,  
RM12 6NB, Tel: 01708 472791

**Inlet Connection:** 22mm Copper; 1/2" BSP Female Flexible Tails

**Outlet Connection:** M24 Aerator

**Minimum Working Pressure:** 1.0 bar

**Maximum Working Pressure:** 5 bar

**Maximum Static Pressure:** 10 bar

**Maximum Inlet Temperature:** 65°C

**Maximum Bath Thickness:** 10mm

## Components:

Identify all components are present prior to installation.

- |     |                     |     |                  |
|-----|---------------------|-----|------------------|
| 1.  | Plug                | 16. | Pop-Up Cable     |
| 2.  | Plug Washer         | 17. | Mixer Body       |
| 3.  | Adjusting Nut       | 18. | O-Ring           |
| 4.  | Adjusting Screw     | 19. | 2x Elbows        |
| 5.  | Flange Screw        | 20. | 2x Blanking Caps |
| 6.  | Flange              | 21. | Rubber Washer    |
| 7.  | Moulded Washer      | 22. | Washer           |
| 8.  | Waste Body          | 23. | Washer           |
| 9.  | Conical Washer      | 24. | Shroud           |
| 10. | Plastic Nut         | 25. | Lock Nut         |
| 11. | Plastic Bush        | 26. | Pop-Up Handle    |
| 12. | Conical Washer      | 27. | Handle Lever     |
| 13. | Plastic Washer      | 28. | Rubber Washer    |
| 14. | Plastic Nut         | 29. | Aerator          |
| 15. | Flexible Waste Tube | 30. | Outlet Housing   |
|     |                     | 31. | Flexible Tails   |

# Installation

1. Push the moulded washer (7) through the waste hole in the bath, with the smaller side pushed through the top. Make sure all edges are flush to the bath surface.
2. Offer the waste body (8) below the bath, with the flange (6) at the top. Secure using the flange screw (5).
3. Fit the mixer body (17) to the overflow location, ensuring rubber washer (21) is in place behind the bath. Place the two washers (22, 23) on the other side of the bath and screw on the shroud (24). Secure in place with the locking nut (25).
4. Fit the handle (26 & 27) to the control spindle by pushing on firmly.
5. This product needs to be fitted to a fitting(s) that can control the water supplies. This can be to separate hot and cold water supplies, or a single mixed outlet water supply. To fit separate hot and cold water supplies, the blanking caps (20) will need to be removed.
6. Connect your water supply(ies) to the inlets (19) using the flexible tails supplied (31) and any other necessary fittings.
7. Connect flexible waste tube (15) to the waste body (8) using the plastic nut (14).
8. Squeeze the other end of the flexible waste tube (15), push into the mixer body (17) ensuring it goes past both O-Rings.
9. Connect your waste pipework to the waste body (8), securing with the conical washer (9) and plastic nut (10). Turn on the water supply and check all joints and connections for leaks.
10. Test operation by turning the handle (26) to see if the plug (1) pops up sufficiently. If necessary, the plug can be adjusted by loosening the nut (3) and unscrewing the adjusting screw (4) so that it's touching the operating lever inside the waste body (8).

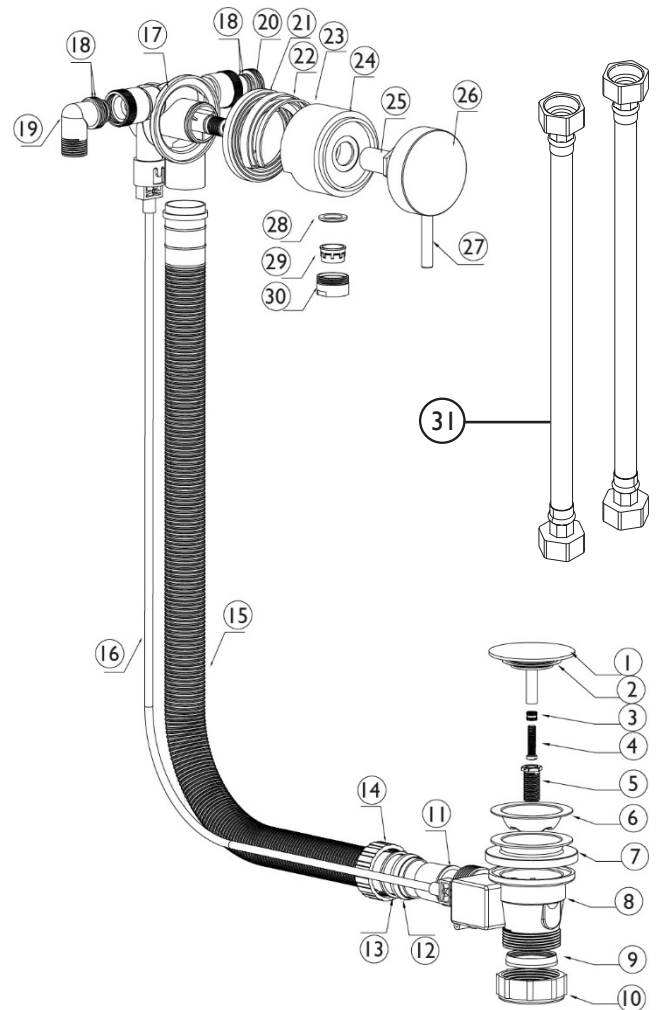

## General Cleaning

Bristan products are made from premium materials, with hand polished, PVD, EPD or electroplated finishes.

Your tap should be regularly cleaned with warm water, a mild pH-neutral liquid soap, and polished with a soft cloth. Any residues from soap, toothpaste, shampoos and shower gels can cause blemishes if not rinsed off straight after use.

Household bleaches and cleaners contain harsh chemicals and may damage the surface finish. Avoid using abrasive cloths, scouring pads, scrub sponges, steel wool or anything similar.

Issue: D5

Part Number: W BATH09

# **BRISTAN**

## **Bristan Group Ltd.**

**UK:** Bristan Group, B78 1SG.

**EU:** Masco Europe S.à.r.l.  
14 Rue Strachen  
6933 Mensdorf  
Luxembourg

**Customer Service:** +44330 026 6273

**Web:** [www.bristan.com](http://www.bristan.com)

**Email:** [enquire@bristan.com](mailto:enquire@bristan.com)

## **A Masco Company**

At Bristan, we want to make things as easy as possible for our customers. That's why we offer solid guarantees on all our products, effective from the date of purchase, to give you peace of mind.

To start your free guarantee simply scan the QR code and register your product.  
Alternatively visit [www.bristan.com/register](http://www.bristan.com/register).

For any other queries, please call our Customer Service on **0330 026 6273** where our expert team of advisors will be able to offer you any help and advice.

For full guarantee terms and conditions visit [www.bristan.com/service-centre/guarantees](http://www.bristan.com/service-centre/guarantees).

