

Technical Datasheet

Product Code: SY-ANGELSEAT

Product Description: Angel Standard Seat



Specification

Material:	Polypropylene
Shape:	Round
Packaged Weight (kg):	2 kg



Key Features

- Pure & luxurious modern design ideal to boost your bathroom décor
- Manufactured from high quality polypropylene
- Soft close seat for minimal noise & added safety measure
- Only compatible with Arley Angel close coupled pan

Technical Drawing

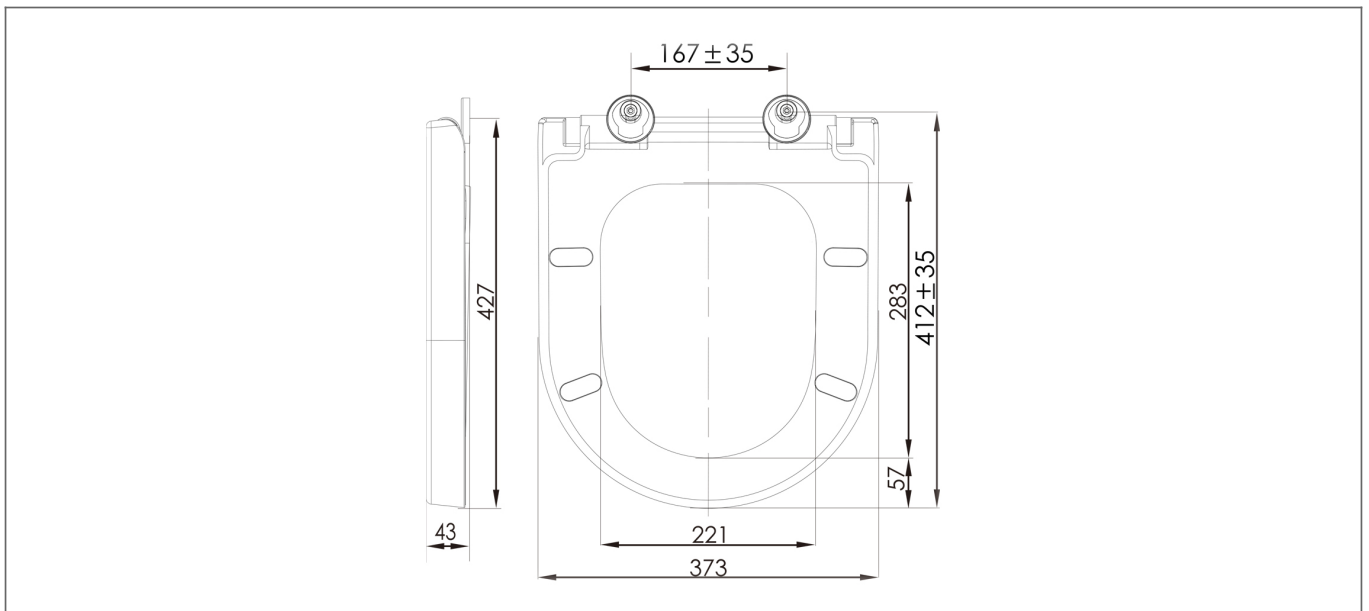

Dimensions: All measurements are in millimetres and are subject to normal manufacturing variations.

Due to a continuing development programme to improve design and performance, we reserve all rights to vary specifications without prior notice. Please note, all accessories are for photographic purposes only.