

## Warranty Information

Proof of purchase will be required.

The guarantee does not cover faults or damage caused by incorrect installation and/or maintenance, ordinary wear and tear, water composition, etc.

\*Please see [www.methven.com](http://www.methven.com) for full terms and conditions of warranty

## Cleaning

Your product has a high-quality finish and should be treated with care to preserve the visible surfaces. Never use abrasives or abrasive cleaning agents to clean this product clean regularly with contamination free warm water and a damp soft cloth. Do not use products containing chlorine bleach or hydrochloric acid as these can damage the product.

We have a policy of continuous improvement and reserve the right to change specifications without notice.

METHVEN UK LIMITED  
METHVEN EXPERIENCE CENTRE  
3/3A STONE CROSS COURT  
YEW TREE WAY  
GOLBORNE  
WARRINGTON  
WA3 3JD  
UNITED KINGDOM

TEL: 0800 195 1602  
FAX: 0844 406 8690  
EMAIL: [sales@uk.methven.com](mailto:sales@uk.methven.com)  
[www.deva-uk.com](http://www.deva-uk.com)  
[www.methven.com](http://www.methven.com)

WST13Cp, WST13BB, WST13BK,  
WST13BN, WST13GM

INST-WST13CP-V1 - 17-2-23

# Free Flow 1 1/4" Unslotted Waste

## WST13CP, WST13BB, WST13BK, WST13BN, WST13GM Installation Guide

---

### Technical Specification

#### Operating Pressure

Min: N/A

Max: N/A

#### Operating Temperature

Hot: N/A

Cold: N/A

#### Inlet Connections:

1 1/4" BSP

### Features:

- Allows water to flow continuously, reducing the risk of flooding
- For basins without an overflow
- WST13CP Chrome Finish



**METHVEN**  
[www.methven.com](http://www.methven.com) EST 1886

Please keep these instructions for future reference and request of replacement parts.

## General Safety Information

Please read all of the instructions before installation.

Methven recommends this product is installed by a competent person in compliance with all relevant regional regulations. Remove all packaging and check the components for damage before starting installation.

This product must not be modified in any way as this will invalidate the guarantee. It is the responsibility of the installer to ensure a waterproof seal is achieved, after installation all connections must be checked for leaks.

This waste is designed to “never close” - it covers the hole only and allows water to continuously flow down the drain.

## Installation Instructions

- 1) Place the basin waste into the basin and through the hole, to connect underneath.
- 2) Sealant must be applied to the underside of the waste flange to seal between the waste and basin.
- 3) Once fitted, on the underside of the basin feed the rubber seal flange washer up the tail for the waste. Again sealant can be used to seal between the washer and the basin.
- 4) Feed the smaller backnut washer onto the bottom of the waste tail and using the locking backnut, tighten until the waste is secure. As above sealant can also be used.
- 5) Attach the trap/waste pipework to the bottom of the waste body and test for leaks.

## Diagram

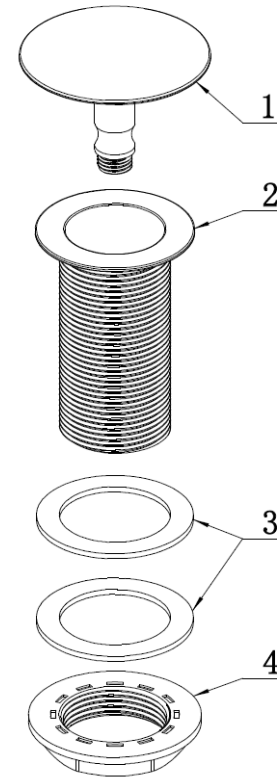

No.	Description
1.	Cover
2.	Waste Body
3.	2 x Washers
4.	Backnut

## Line Drawing

Unit of measure: mm

