

HiB

MAKING
BATHROOMS
BEAUTIFUL

VANQUISH CABINET

Vanquish 50: Art No 47600 / Vanquish 60: Art No 47700

Vanquish 80: Art No 47800 / Vanquish 120: Art No 47900

VANQUISH TRIM SET

BLK 50: Art No 55100 / BBR 50: Art No 55500

BLK 60: Art No 55200 / BBR 60: Art No 55600

BLK 80: Art No 55300 / BBR 80: Art No 55700

BLK 120: Art No 55400 / BBR 120: Art No 55800

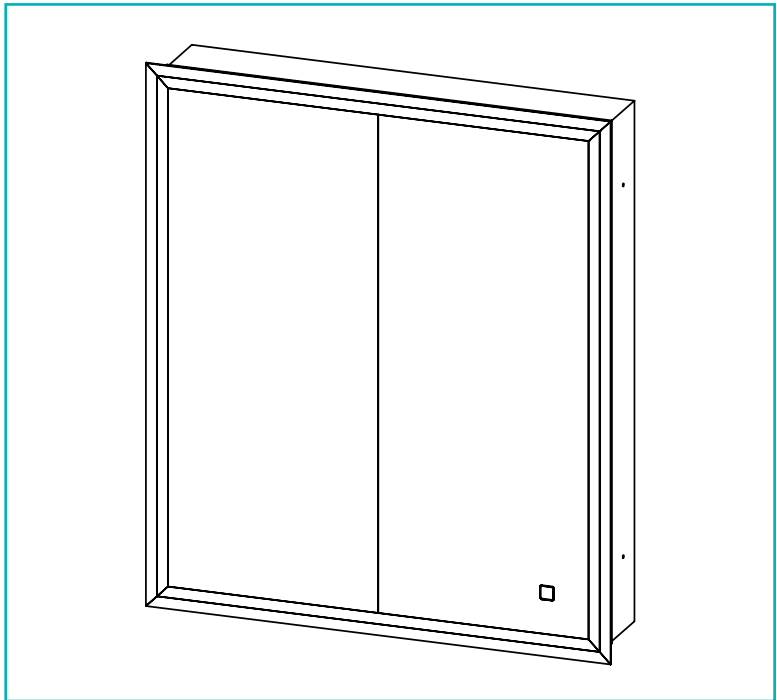

Thank you for purchasing this HiB product.

Please read through these instructions carefully and refer back to them during installation to ensure that your product is fitted safely and that it retains its high quality finish.

Fitting Instructions

Electrical Safety Information

HiB recommends that all electrical bathroom products must be installed in accordance with current building and wiring regulations.

If in doubt please contact an electrician.

Before drilling ensure that there are no hidden cables or pipes in the wall.

Warnings for Safe Use

- This product is intended for Domestic Use only.
- Please read the instructions and warnings carefully before installing the product and ensure this document is kept with the product for future reference to ensure product longevity and in the interest of safety.
- If you give the product to another person, please give them this manual as well.
- If any modification is made it will invalidate the warranty and may render the product unsafe.
- This product is IP44 rated and suitable for installation in Zones 2 and Outside Zones according to the IEE regulations.
- It is not suitable for use in saunas, steam rooms and shower cubicles.
- Appropriate circuit protection should be available for the product.
- When drilling use appropriate eye protection.
- The use of a Residual Current Device (RCD) is advised for any power tools used during the installation of this product.
- Take suitable precautions when handling glass.
- Beware of hidden cables or pipes. Take care if drilling on tiled surfaces in case the drill slips.
- Always switch off the electrical supply to the product at the mains during installation and maintenance.
- It is recommended that this product is installed by a person who is able to meet the level of competence required in order to comply with relevant regulations. If in doubt consult a qualified tradesperson.
- Do not enter IP44 box unless competent and item is isolated from mains.
- Do not use if glass is broken or unsafe.
- Do not use if any electrical wires appear damaged or degraded.
- Do not overload shelves or unit.
- This product is designed for installation into a brick or masonry block wall, if mounting onto other substrate ensure appropriate fixing and batons (if required) are used and the load bearing of the wall is sufficient.
- It is recommended that this product is installed by two people.
- Dispose of packaging in accordance to local authority regulations.
- At end of life dispose of item according to local authority regulation.

Electrical Information

This product contains a light source of energy efficiency class **E**



Fig 1. - Zonal Diagram

All installations must comply with guidelines which are based on a zonal concept and must be followed to ensure the safe installation of electrical appliances in the bathroom.

These regulations apply to domestic installations only. Installations must be made in accordance with the current IEE wiring regulations and relevant building regulations.

This product is IP44 rated and is suitable for installation in zones: **2 & Outside Zone**

Wiring Diagram

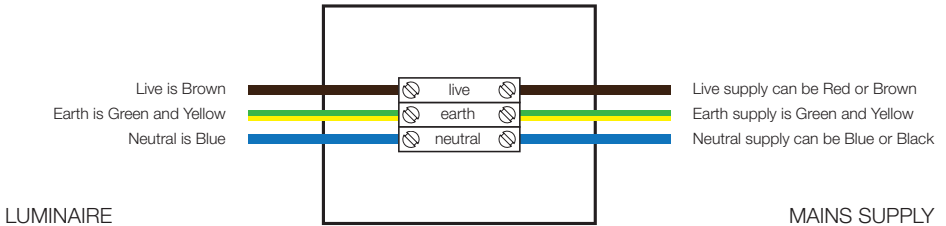

What's in the Box?

Cabinet and Trim set sold seperately.

Vanquish Cabinet:

- Vanquish Cabinet
- Glass shelves
- Mounting bracket
- Fittings pack

Trim Set:

- Trim
- Fittings pack

Tools Required



Pencil

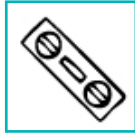

Spirit Level



Drill



Drill bit



Screwdriver

Adjustment

- Move door(s) up/down

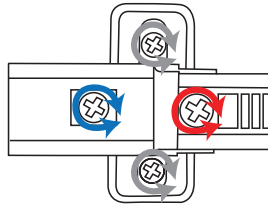
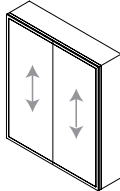

- Move door away/towards the cabinet

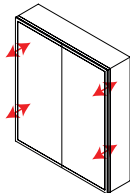

- Move door(s) left/right

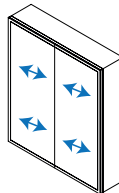

Door Adjustment

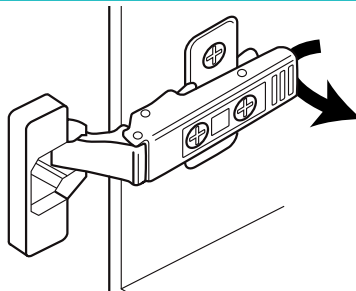

Door Removal

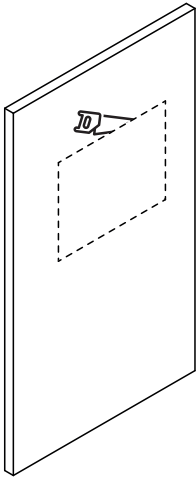

Fig 2.

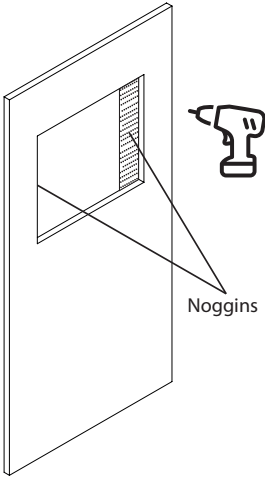

Fig 3.

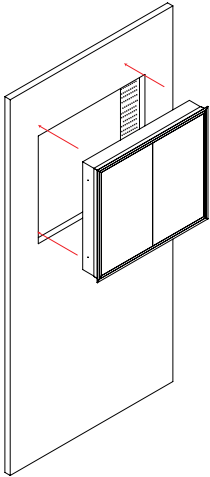

Fig 4.

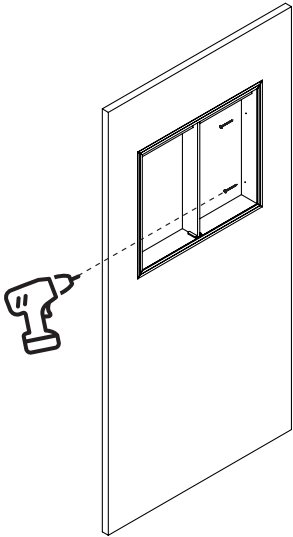

Fig 5.

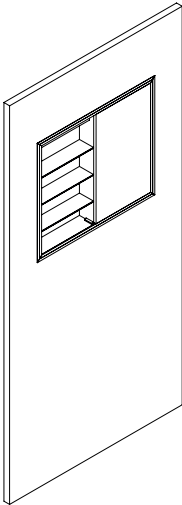

Fig 6.

Cabinet Installation

Before installation, ensure the domestic electrical mains supply to which the cabinet is to be connected is turned off. Before drilling, ensure that there are no hidden cables or pipes in the wall.

It is recommended that this product is installed by two people.

This product can only be recessed fitted into a wall. Before installing ensure you take note of measurements of the recessed area and the side fixing points inside the cabinet carcass (See fig. 2 & 5).

You may need to remove the door / doors to make it easier to fit, see Door Removal page 4. Do not fit the shelves until product is installed correctly.

If a separate trim set has been purchased this will need to be fitted onto the cabinet, prior to full installation. Please see trim set installation guide on page 7.

1. Measure the dimensions of the cabinet carcass (excluding the front aluminium fascia trim).
2. Using these dimensions, take a soft pencil and mark the outline for the required aperture in the wall. Take great care to mark this accurately, straight and level.
3. Using an appropriate tool, cut or channel out the aperture in the wall where the cabinet will fit, *see Fig. 2*.
4. If it is necessary, install supporting baton(s) or noggin(s) around the recessed area, *see Fig. 3*, to which the cabinet can be secured. These supports must be completely vertical and parallel to the cabinet to prevent the cabinet twisting when fitted.
5. Connect the cabinet to the domestic mains supply according to the wiring diagram, *see page 3*, and position the cabinet into the wall aperture, *see Fig. 4*.
6. Using a suitable screwdriver or drill, secure the cabinet into the wall aperture, via the two holes located on the internal edge of the cabinet using the supplied screws (two on each side) *see Fig. 5*.
7. Insert the metal shelf supports in desired position. Install each glass shelf into shelf supports and tighten the plastic grub screw on the underside. This will securely clamp the shelf into position, *see Fig. 6*.
8. If necessary, hinges can be adjusted to reposition the door(s) *see Door Adjustment on page 4*.
9. Switch mains supply back on.

Trim Installation

1. Detach the existing aluminium trim by removing screws located around the edges using a suitable screwdriver.
2. Assemble the new trim set using the four supplied corner brackets and screws, ensuring the angled joints are tight and closed. *See Fig 7 & 8.*

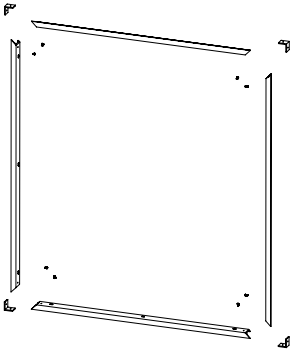

Fig 7.

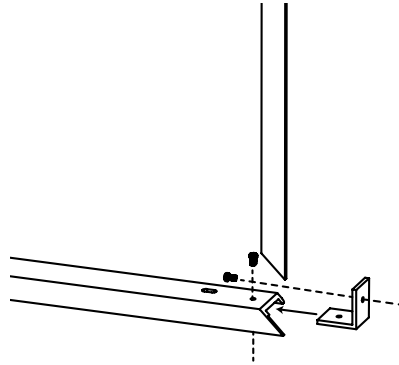

Fig 8.

3. Slide the trim frame over the cabinet and position in line with the securing holes on each side of the cabinet carcass. *See Fig 9*
4. Secure the new trim frame in place using the supplied screws and washers
5. Follow cabinet installation instructions opposite to complete install.

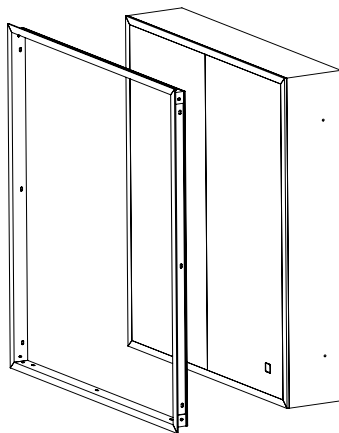

Fig 9.

Operation

Illumination ON/OFF

Touch the sensor button once.

Change the Colour Temperature of the Illumination

Touch and hold the sensor button until desired colour is obtained.

The colour temperature is set until changed again.

Heated Pad

The heated pad is only on when the cabinet is illuminated.

Charging Socket(s) and USB

Charger socket(s) are suitable for charging and powering electric razors, trimmers and toothbrushes. Some cabinets may contain multiple charging sockets. *NB. On first use of the charger socket, inserting the plug may prove to be stiff. Reasonable force may be required to fully insert the plug. After a few uses, stiffness will ease and the socket will function as normal.*

Care

To preserve the high quality finish of your HiB product, please ensure you regard the following care and cleaning recommendations:

- Avoid leaving excessive standing and surface water on the product for prolonged periods of time.
- Clean the product with water and a soft cloth, a mild detergent may be used if required. Ensure any excess moisture is removed after use.
- **Do not use** abrasive sponges or cleaning agents.

Aftercare

In the unlikely event that this product should fail please contact the retailer from which the item was purchased.



WEEE compliance

Must not be mixed with
general household waste

T: +44 (0)20 8441 0352 F: +44 (0)20 8441 0219 E: sales@hib.co.uk hib.co.uk

Building 3, North London Business Park, Oakleigh Road South, New Southgate, London. N11 1GN

©HiB Copyright: No part of this document may be reprinted or duplicated without HiB consent. All sizes and measurements are approximate, but we do try and make sure they are as accurate as possible. In the interest of continuous product development, HiB reserves the right to alter specifications as necessary. E & OE.