

9.

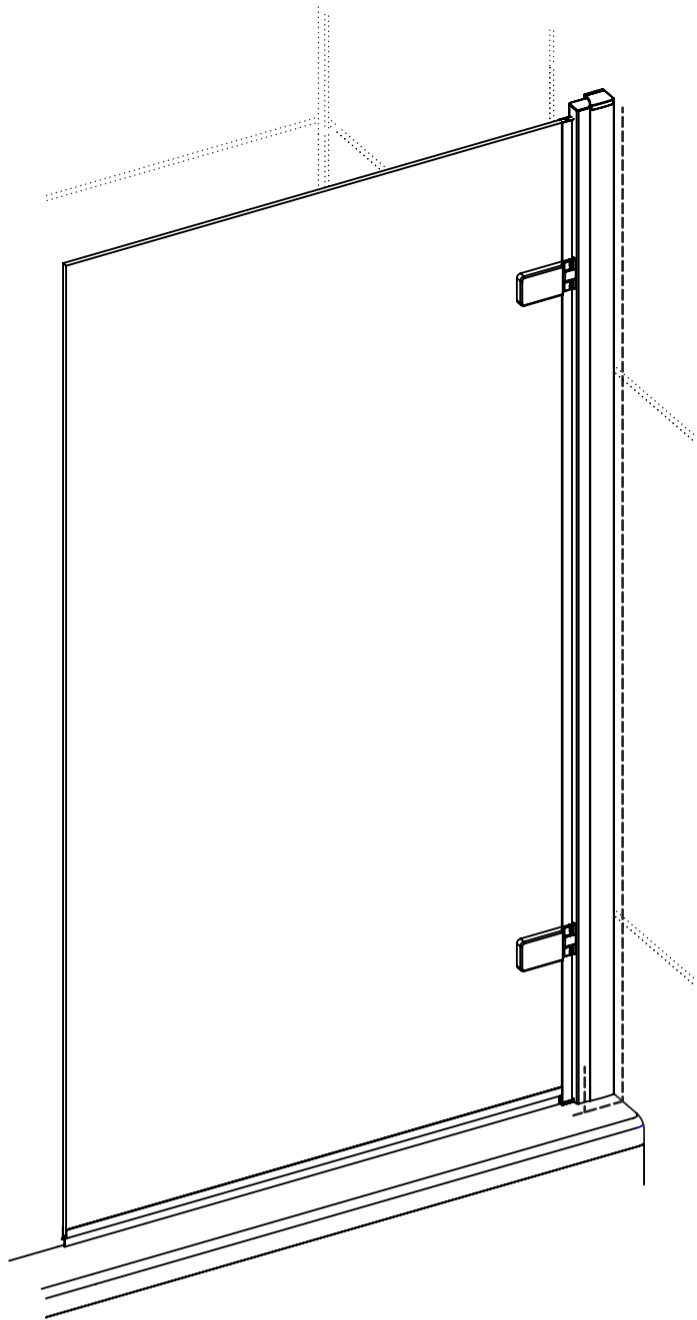

EXTERNALLY SILICONE SEAL THE WALL PROFILE WHERE IT MEETS THE WALL AND 150mm HIGH AS SHOWN IN THE DETAILED VIEW BELOW.

ALL IN A CONTINUOUS BEAD.

AFTERCARE - ENSURE YOU CLEAN YOUR PRODUCT USING A MILD DETERGENT DILUTED IN WATER, REMOVING ANY RESIDUE WITH A SOFT DAMP CLOTH.

MAINTENANCE - ENSURE MOVING PARTS ARE FREE FROM ANY DEBRIS OR SOAP BUILD UP.

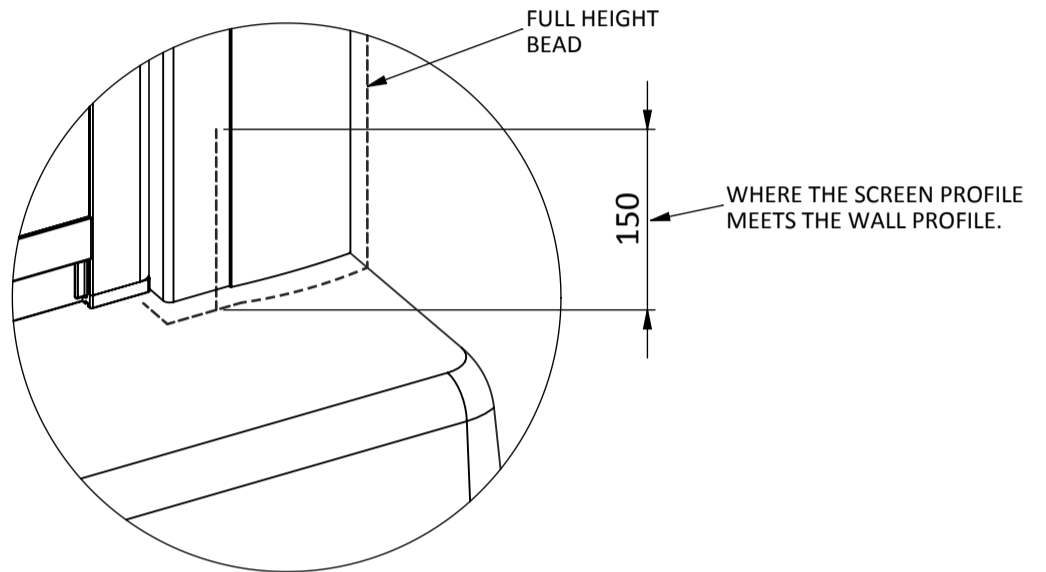

180° HINGED BATH SCREEN

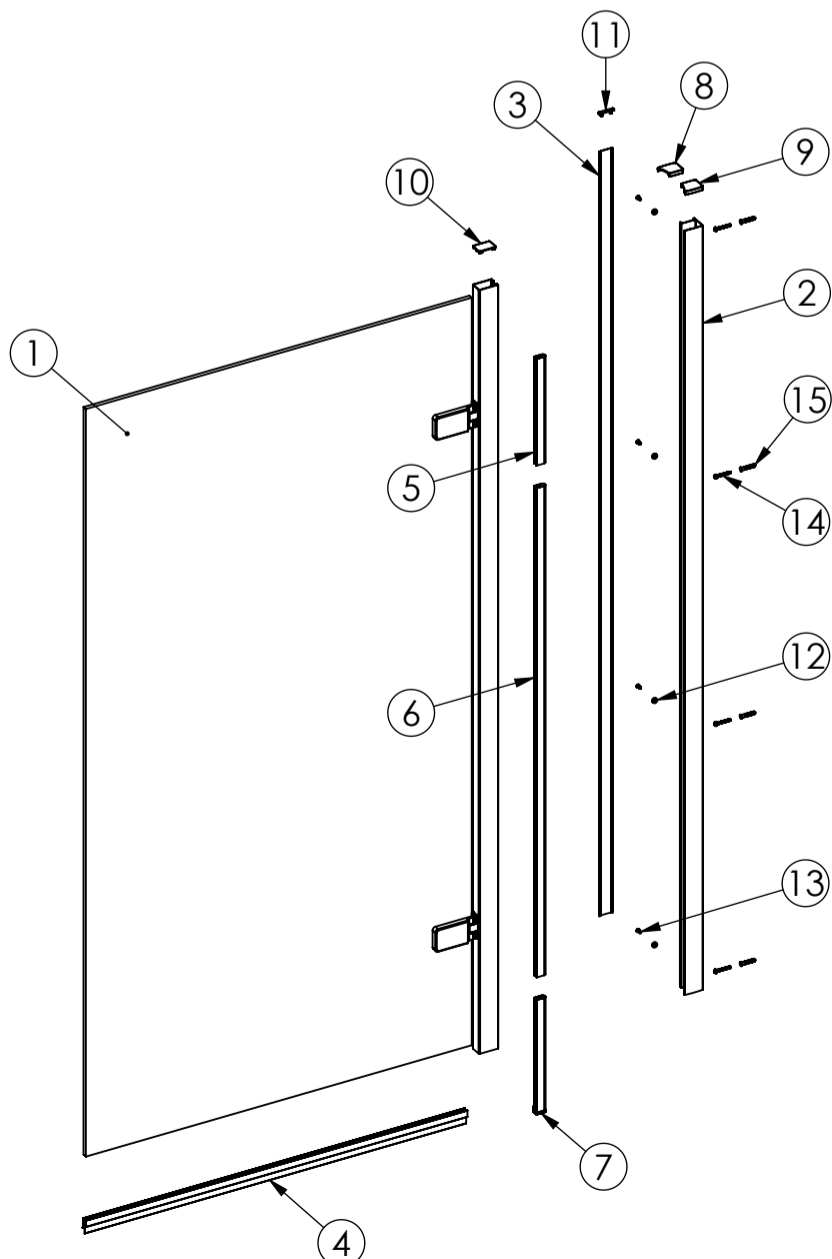

UNPACK THE BOX AND ENSURE ALL COMPONENTS ARE PRESENT.

NO REFUND OR REFITTING COST WILL BE GIVEN IF INCOMPLETE OR DAMAGED GOODS ARE FITTED.

THE TOUGHENED SAFETY GLASS SHOULD BE HANDLED WITH CARE AS IMPACTS WILL DAMAGE THE GLASS OR BATH.

TOOLS REQUIRED

POWER DRILL - 3mm DRILL BIT - SUITABLE MASONRY DRILL BIT - CROSS HEAD SCREW DRIVER - TAPE MEASURE - PENCIL - SILICONE GUN WITH SANITARY GRADE SEALANT - SPIRIT LEVEL.

ITEM No.	DESCRIPTION	Notes	QTY
1	SCREEN ASSEMBLY		1
2	WALL PROFILE		1
3	COVER PROFILE		1
4	BOTTOM SEAL		1
5	VERTICAL SEAL (211.5mm)		1
6	VERTICAL SEAL (971mm)		1
7	VERTICAL SEAL ASSEMBLY (227.5mm)	INCLUDING SEAL BLOCK	1
8	WALL PROFILE CAP LH		1
9	WALL PROFILE CAP RH		1
10	SCREEN ASSEMBLY CAP		1
11	COVER PROFILE CAP		1
12	SCREW CUP		4
13	3.9 x 10mm PAN HD SELF TAPPER SCREW		4
14	3.9 x 30mm PAN HD SELF TAPPER SCREW	FOR FIXING TO WALL	4
15	WALL PLUG		4

1.

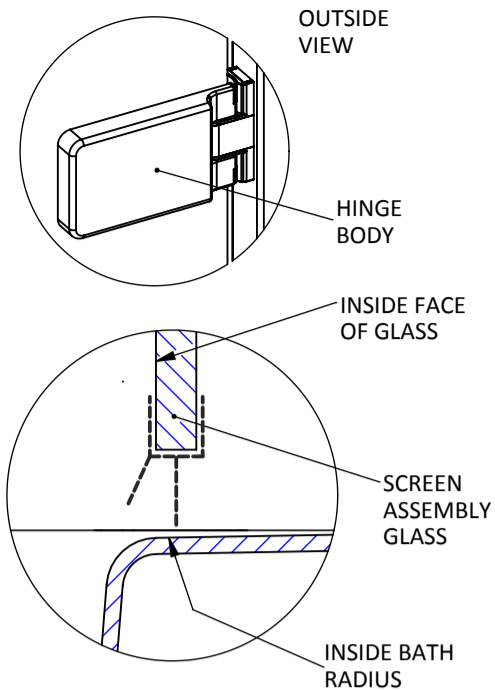

FIRSTLY, PUT THE WALL PROFILE (ITEM 2) ONTO THE END OF THE SCREEN ASSEMBLY PROFILE (ITEM 1).

ROTATE SCREEN ASSEMBLY DEPENDING ON LH OR RH REQUIREMENT. THE HINGE BODY SHOULD BE FACING OUTWARDS.

POSITION THE SCREEN SO THAT THE INSIDE FACE OF THE GLASS IS TO THE INSIDE RADIUS OF THE BATH; AS SHOWN ACROSS.

CHECK SQUARE AND TRUE WITH A SPIRIT LEVEL AND MARK POSITION OF WALL PROFILE WITH A PENCIL.

REMOVE ASSEMBLY.

2.

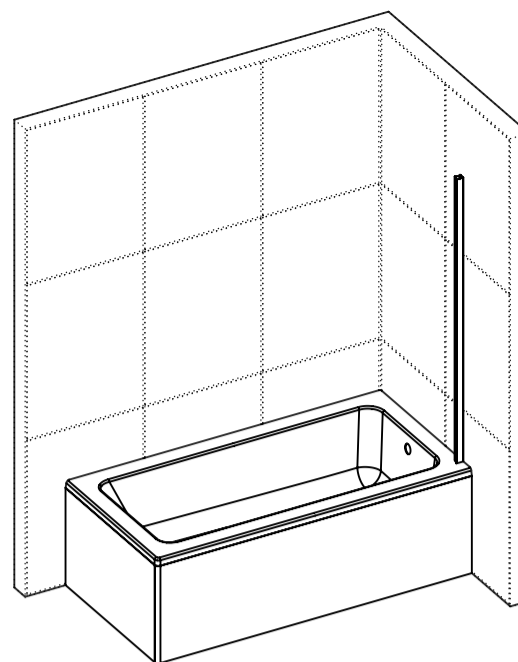

REPLACE WALL PROFILE WHERE MARKED AND MARK THROUGH THE FIXING HOLES WITH A PENCIL.

DRILL AND PLUG THE WALL WHERE MARKED USING A SUITABLE MASONRY DRILL BIT.

NOTE: THE WALL PLUGS PROVIDED MAY NOT BE SUITABLE FOR THE SUBSTRATE YOU'RE FIXING TO. USE SUITABLE FIXINGS.

FIX THE WALL PROFILE IN PLACE USING ITEM 14.

3.

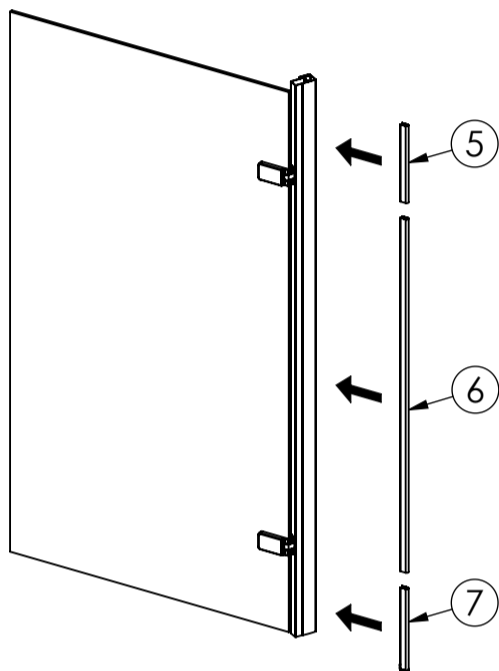

FIT THE VERTICAL SEALS (ITEMS 5, 6 & 7).

ENSURE THAT THE SHORTEST SEAL (ITEM 5) IS FITTED TO THE TOP OF THE SCREEN AND THE SEAL WITH A SEAL BLOCK (ITEM 7) IS FITTED TO THE BOTTOM OF THE SCREEN.

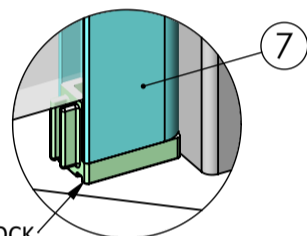

4.

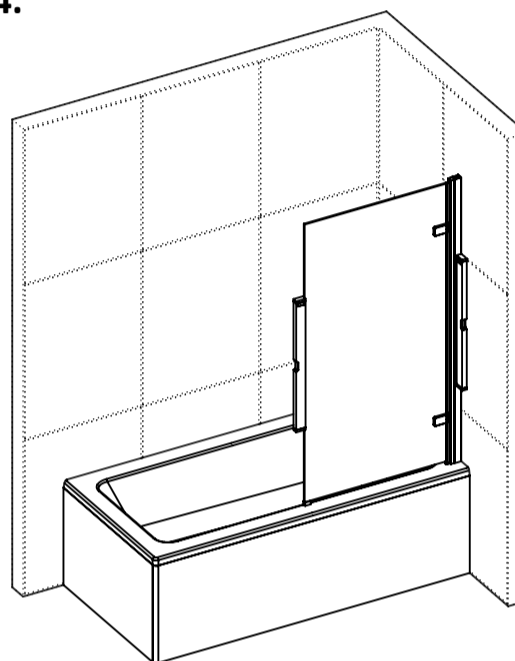

SLIDE THE SCREEN ASSEMBLY (ITEM 1) INTO THE WALL PROFILE. THE BOTTOM EDGE OF THE GLASS MUST BE PARALLEL TO THE BATH TOP FACE. A 19mm PACKER UNDER THE GLASS PANEL CAN BE USED TO AID FITTING.

POSITION THE SCREEN ASSEMBLY SO THAT THERE'S AN ADEQUATE AMOUNT OF MATERIAL TO DRILL AND FIX TO, THROUGH THE HOLES PROVIDED.

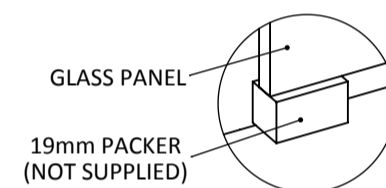

5.

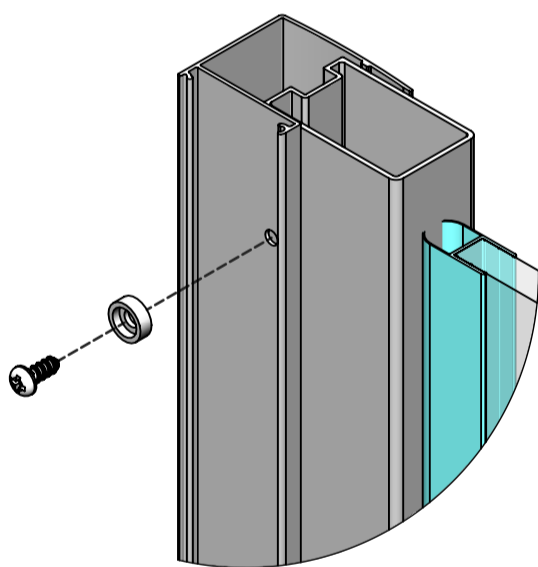

FIX YOUR SCREEN IN PLACE, USE A 3mm DRILL BIT AND DRILL THROUGH THE HOLES IN THE WALL PROFILE.

ENSURE YOU ONLY DRILL THROUGH ONE WALL THICKNESS.

FIX THE SCREEN USING ITEMS 12 & 13.

6.

ONCE SECURED IN PLACE REMOVE THE PACKER AND FIT BOTTOM SEAL (ITEM 4).

ENSURE THAT THE LONG VERTICAL BLADE ON THE BOTTOM SEAL HAS BEEN INSERTED BETWEEN THE TWO SEAL BLOCK FINS AND THAT THE ANGLED BLADE IS TO THE INSIDE OF YOUR BATH.

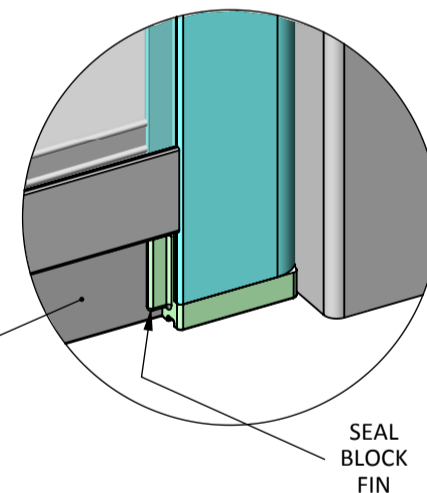

7.

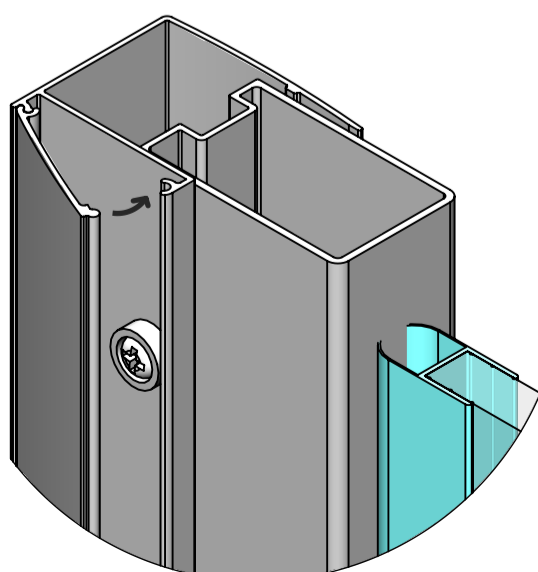

TO FIT THE COVER PROFILE (ITEM 3) HOOK AT THE REAR FIRST THEN SNAP INTO PLACE.

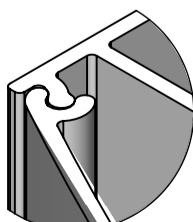

8.

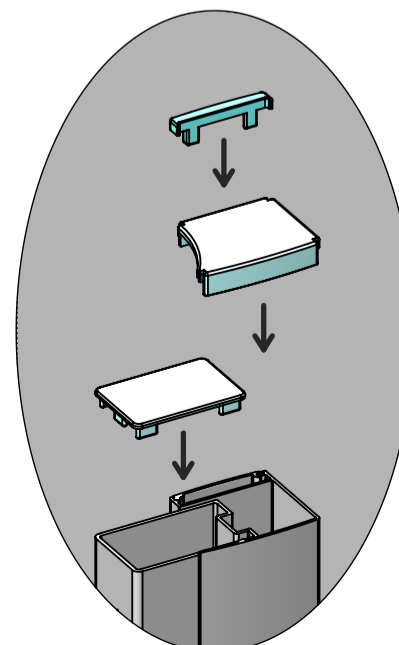

FIT APPROPRIATE CAPS AS SHOWN (ITEMS 8/9, 10 & 11).