

Specification

Tolerance Guidelines (Carcase Assembly)

Doors:
Doors including edge band (if required) + or - 0.5mm

Carcase:
Rails and Shelves + or - 0.5mm

Squareness:
Panels to be checked back to back + or - 1.0mm per linear metre
Panels corner to corner (diagonal) + or - 1.0mm per linear metre

Drilling:
Visible holes must be clean of chipping on circumference
Location + or - 0.5mm
Diameter + or - 0.1mm
Depth + or - 0.5mm
Countersunk hole depth no greater than 1.5mm depth
Spikes must be clearly visible

Groove / Slot / Rebate:
Depth + or - 0.5mm
Width + 0.5mm or - 0.0mm
Distance from Datum Edge + or - 0.5mm

Chipping:
A Face is visible at all times – no chipping allowed
B Face is intermittently visible – no chipping allowed
C Face is not visible – intermittent allowed

Refer to quality documentation and any relevant customer specification for more concise tolerance guidelines

IF IN DOUBT ASK!

Cabinet Number	Quantity
----------------	----------

5

1

Customer

Summerbridge

Sales Order

SO

Reference

Buckingham Traditional Range

Product

BUS600MIR-B

Size

H570 x W600 x D182

Print Date

27/07/23 @9:28 AM

summerbridge

Kitchens | Bedrooms | Bathrooms | Doors | Cabinets

182

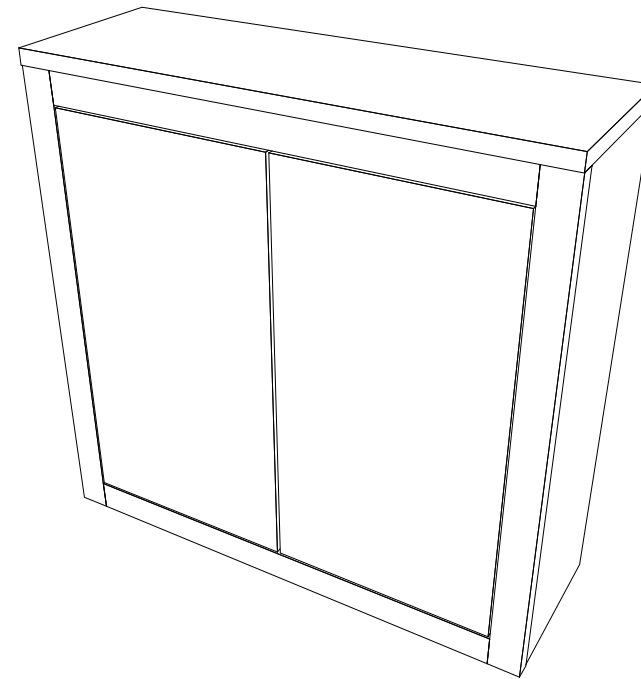
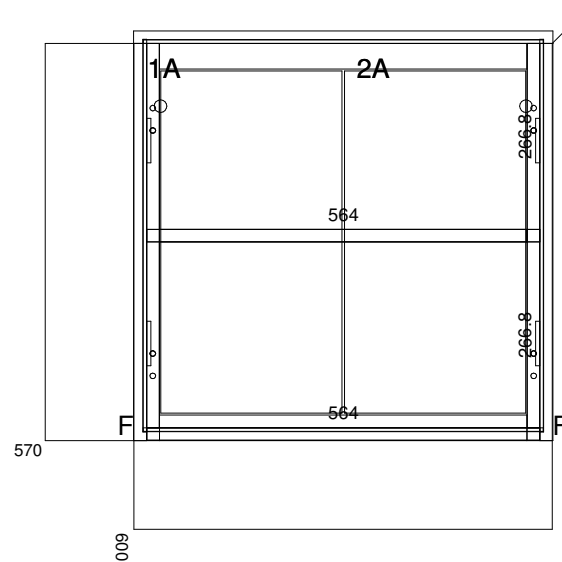

Doors	Quantity	Width	Height	Material	Material
2	491	259.5	182	Slab	18mm Vinyl Panel
Panel Stock					
1	570	182		Vinyl Left End	18mm Generic MDF
1	570	182		Vinyl Right End	18mm Generic MDF
1	561.5	574		Unfinished Back	18mm Lissa Oak
1	564	181.5		Bottom	18mm Lissa Oak
1	570	37		Vinyl Left Stile	18mm Generic MDF
1	570	37		Vinyl Right Stile	18mm Generic MDF
1	527	37		Vinyl Bottom Rail	18mm Generic MDF
1	527	37		Vinyl Top Rail	18mm Generic MDF
1	601	201.5		Vinyl Top	18mm Generic MDF
1	551.5	62		Vinyl Left Packer	18mm Generic MDF
1	551.5	62		Vinyl Right Packer	18mm Generic MDF
1	564	144.5		Fixed Shelf	18mm Lissa Oak
Hardware					
4	63.5	25.4		Hinge	110D Slyder S/C Hinge
Fittings					
10	8MM DOWEL				
1	FIXING BLOCK				
14	SCREW				

Comment
Created 23Aug2022 - GS
Buckingham Traditional Mirror Wall Cabinet 600mm
Fixed Shelf dry dowel fit to Vinyl Side
Modified 10Jul2023 - RA - Top changed from 22mm to 18mm MDF. reduced by 1mm in the width