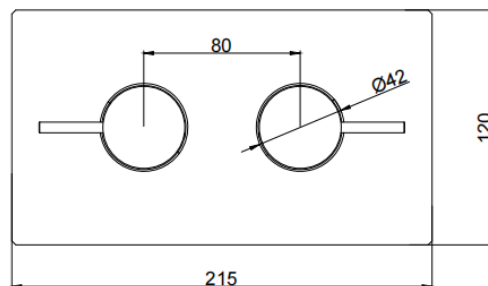
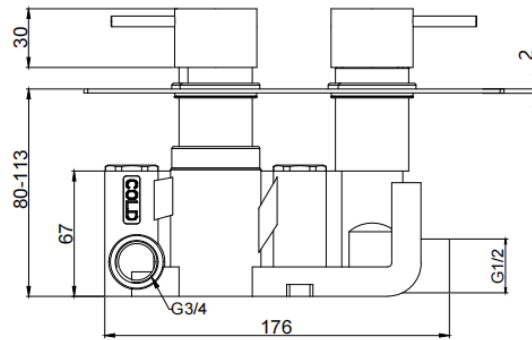

**SHO045NR- Nero Round Concealed Therm. Shower Valve Matt Black**

**BAR CODE: 5055681437824**
**COLOUR: MATT-BLACK**
**WEIGHT:**
**NET 2.37 kg**
**GROSS 2.73 kg**
**STANDARDS: BS EN 1111**
**NOTES:**
**SUITABLE FOR PRESSURES BETWEEN 0.2 - 5 BAR**
**HOT & COLD PRESSURES MUST BE BALANCED**
**SUITABLE FOR COMBI- BOILERS, UNVENTED MAINS**
**PRESSURE SYSTEMS AND GRAVITY FED SYSTEMS**
**SUITABLE FOR SHOWER PUMPS**
**Flow Rate:**

| 0.2 bar | 0.5 bar | 1 bar  | 2 bar  | 3 bar  | 5 bar  |
|---------|---------|--------|--------|--------|--------|
| 5.7 L   | 9.6 L   | 13.6 L | 19.8 L | 24.5 L | 28.5 L |

**BOX SIZE 263x165x160**