

RAK-RESORT - RAKRSTFSU65603

Cloakroom Vanity Unit, None

RAK
CERAMICS

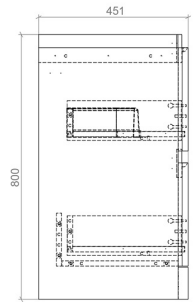
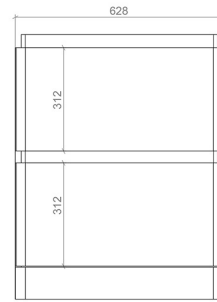
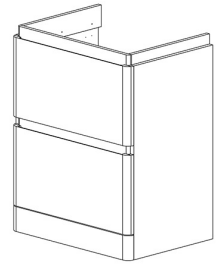

TECHNICAL SPECIFICATIONS

Suite:	RAK-RESORT
Type:	Cloakroom Vanity Unit
Dimensions:	628 x 800 mm
Weight:	32 Kg
Color:	MATT GREY - 503
Door drawer:	2

Dimensions: All dimensions in mm. Tolerance of vitreous china & fireclay items: $\pm 5\%$ for below 200mm and $\pm 3\%$ for above 200mm; for all other items tolerance $\pm 1\%$. Note: Due to a continuing development program to improve design and performance, the manufacturer reserves all rights to vary specifications without prior information. Please note accessories are for photographic use only.