

SAGITTARIUS

TAPS & SHOWERING

Construction	Brass Body (CuZn40Pb2)
Finishes	Chrome plated to BS EN 248
Product Type	Contemporary
Water Pressure Tested Between	Min. 0.2 bar, Max. 6.0 bar
Standards	N.H.S. Model Engineering Specifications : D08 Thermostatic Mixing Valve (Healthcare Premises)
Certification	Manufactured to comply with TMV3 and WRAS standards
Cartridge	Thermostatic Ceramic disc cartridge
Aerator	Spout aerator
Fitting	15mm compression unions or G1/2" BSP
Guarantee	10 years against manufacturing faults
Additional Information	<ol style="list-style-type: none"> 1. Simple to use, single lever sequential control. 2. Easy to install, fits all single hole basin. 3. Integrated hoses with check valves and strainers. 4. Sequential operation from Off to Cold and Warm to Maximum blending, temperature preset at 41° C, which can be adjusted if required. 5. Approved for High and Low Operating

**THERMOSTATIC TMV3
SEQUENTIAL EXTENDED
LEVER BASIN MIXER
CHROME**

TMV/092/C



Flow Rates (Litres per minute)

System Pressure	0.2 Bar	0.3 Bar	0.5 Bar	1.0 Bar	1.5 Bar	2.0 Bar	3.0 Bar	4.0 Bar	5.0 Bar
	-	-	8.7	12.9	-	16.4	23.0	-	31.0

The information contained on this page was correct at the date of issue. Fitting dimensions are provided as a guide only. Some variation may occur due to manufacturing tolerances. We pursue a policy of continuing improvement in design and performance of our products and so reserve the right to change specifications without prior notice

FOR FURTHER ADVICE PLEASE CONTACT :-

SAGITTARIUS LTD UNIT 1 LOWER VICTORIA STREET—CHADDERTON—OLDHAM—OL9 9TU TEL:0616 6202029

EMAIL:TECHNICAL@SAGITTARIUSTAPS.CO.UK

FLOW DIAGRAM

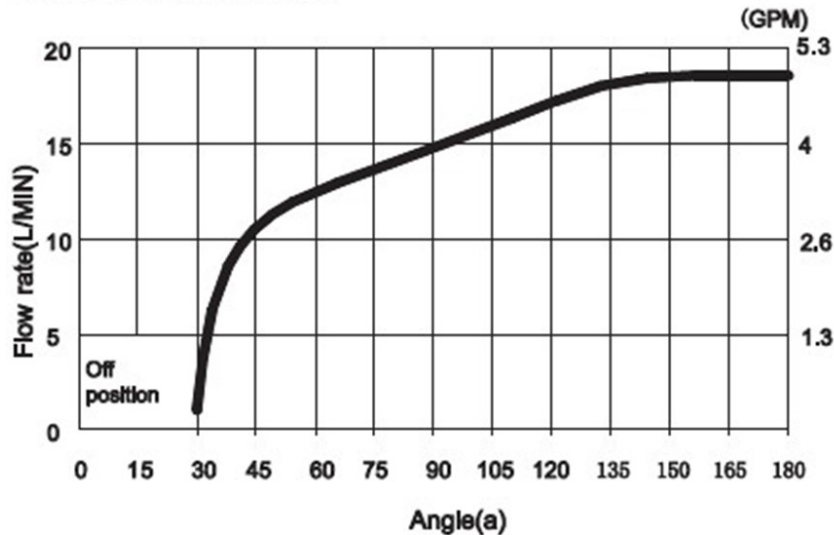

Flow rate curve is for reference only. The actual pressure drop may vary depending on system temperature and pressure.

TEMPERATURE DIAGRAM

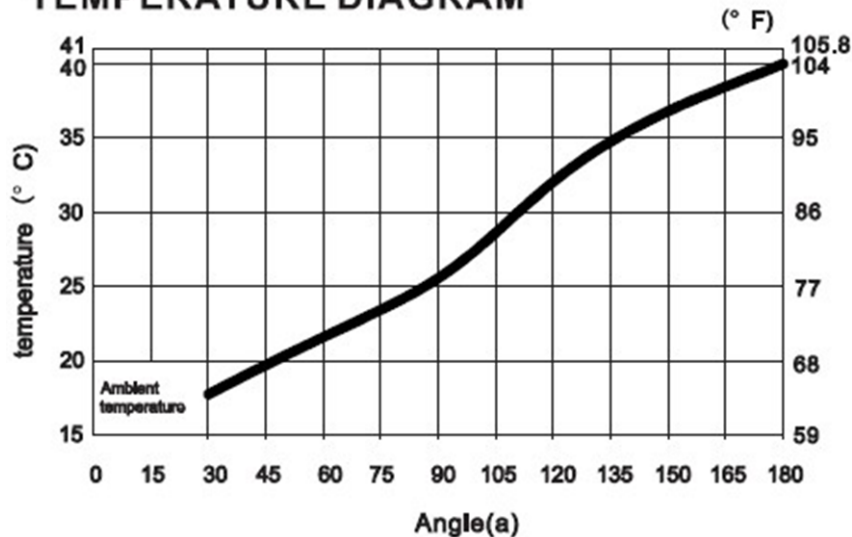

CONDITIONS FOR NORMAL USE

Operating pressure range	High pressure	Low pressure
Maximum static pressure-bar	10 (145psi)	10 (145psi)
Maximum hot temperature	85°C (185°F)	85°C (185°F)
Flow pressure, hot and cold-bar	1 to 5 (14.5psi to 72.5psi)	0.2 to 1 (14.5psi to 72.5psi)
Hot supply temperature-°C	52-65 (125.6-149°F)	52-65 (125.6-149°F)
Cold supply temperature-°C	5 to 20 (41-68°F)	5 to 20 (41-68°F)
Minimum temperature differential (cold/hot to mixed water)	10°C (50°F)	10°C (50°F)

NOTE: Basin mixer operating outside these conditions cannot be guaranteed by the scheme to operate as Type 3 valves.

FOR FURTHER ADVICE PLEASE CONTACT :-

SAGITTARIUS LTD UNIT 1 LOWER VICTORIA STREET—CHADDERTON—OLDHAM—OL9 9TU TEL:0616 6202029

EMAIL:TECHNICAL@SAGITTARIUSTAPS.CO.UK

185

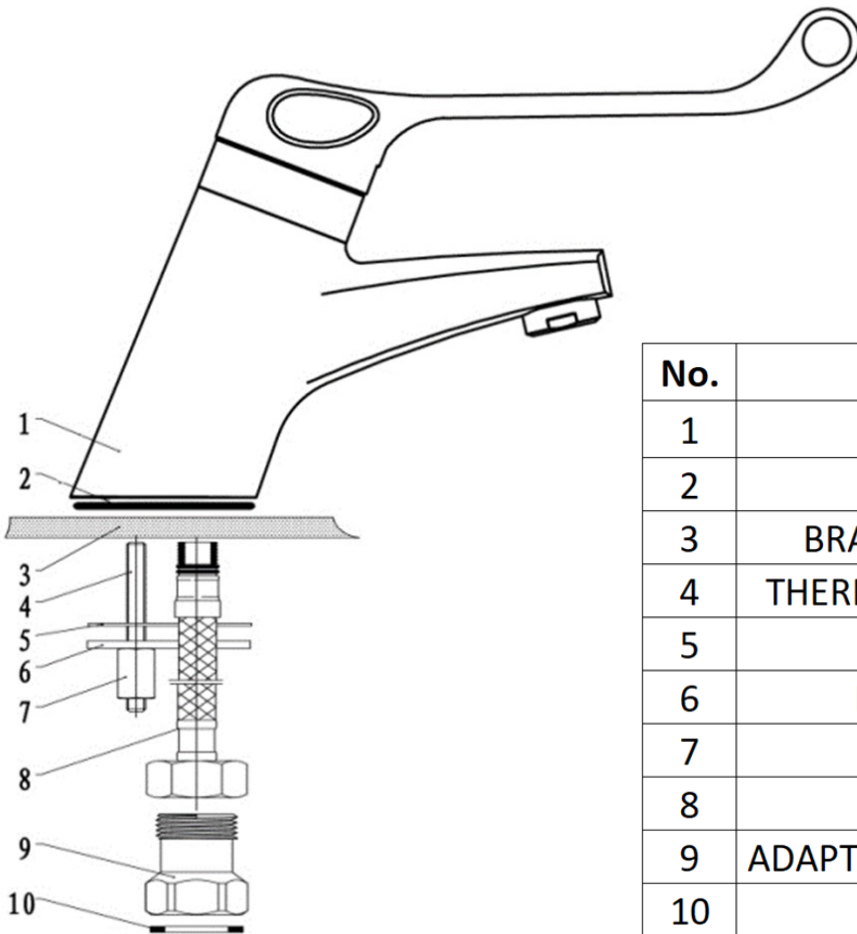
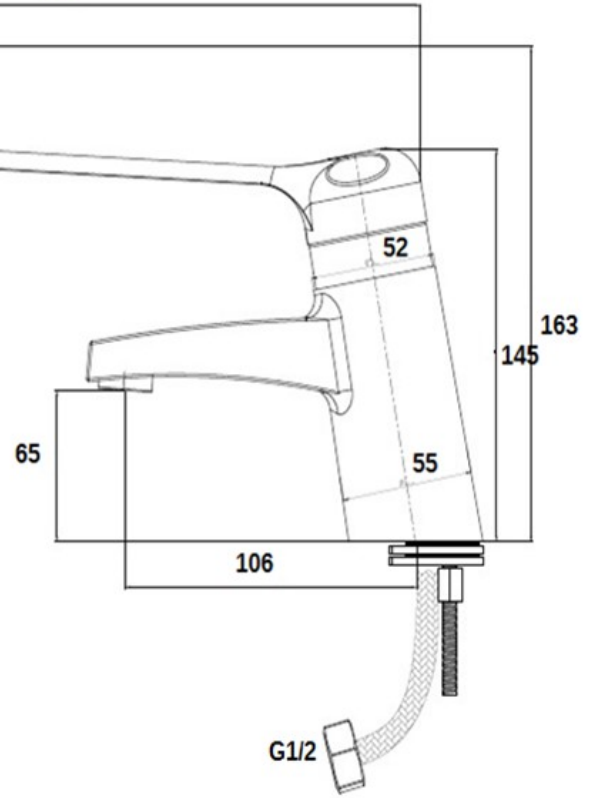
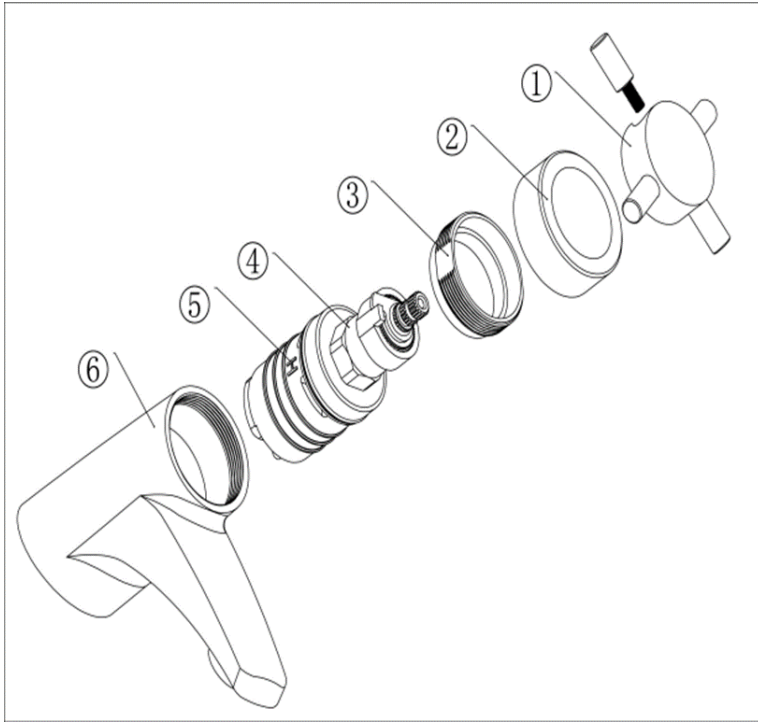

No.	DESCRIPTION	QTY
1	HANLDE	1
2	HANDLE COLLAR	1
3	BRASS CARTRIDGE NUT	1
4	THERMOSTATIC CARTRIDGE	1
5	H/C MARKS	1
6	BRASS TAP BODY	1
7	FIXING KIT SET	2
8	FLEXITAIL	2
9	ADAPTOR WITH CHECK VALVE	1
10	FILTER WASHER	1

FOR FURTHER ADVICE PLEASE CONTACT :-

SAGITTARIUS LTD UNIT 1 LOWER VICTORIA STREET—CHADDERTON—OLDHAM—OL9 9TU TEL:0616 6202029

EMAIL:TECHNICAL@SAGITTARIUSTAPS.CO.UK