

SAGITTARIUS

TAPS & SHOWERING

Construction	Brass Body (HPb59-1), equivalent to BS CZ122; Brass Spout & Diverter handle; Zinc-alloy On/off handle
Finishes	Chrome plated to BS EN 248
Product Type	Contemporary
Water Pressure Tested Between	Min. 0.5 bar, Max. 6.0 bar
Standards	Complies with BS5412, BS EN200
Cartridge	35mm Ceramic disc cartridge
Fitting	M10 x 500mm 1/2" BSP Female Flexible inlet connection hoses supplied
Aerator	M24*1 Spout aerator
Guarantee	10 years against manufacturing faults (excluding serviceable parts)
Additional Information	360° Swivel Spout; Pull-out spray head

**ERGO LEVER PROFES-
SIONAL SINK MIXER
CHROME
EL/281/C**

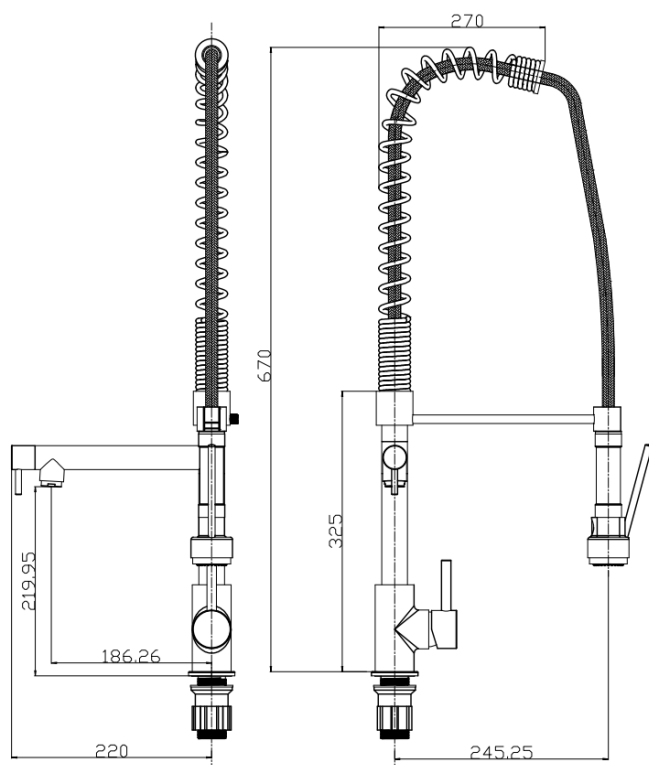

The information contained on this page was correct at the date of issue. Fitting dimensions are provided as a guide only. Some variation may occur due to manufacturing tolerances. We pursue a policy of continuing improvement in design and performance of our products and so reserve the right to change specifications without prior notice

FOR FURTHER ADVICE PLEASE CONTACT :-

SAGITTARIUS LTD UNIT 1 LOWER VICTORIA STREET—CHADDERTON—OLDHAM—OL9 9TU TEL:0616 6202029

EMAIL:TECHNICAL@SAGITTARIUSTAPS.CO.UK

Flow Rates (Litres per minute)

System Pressure	0.1 Bar	0.2 Bar	0.3 Bar	0.5 Bar	1.0 Bar	1.5 Bar	2.0 Bar	3.0 Bar	4.0 Bar	5.0 Bar
	-	2.1	-	5.0	8.0	9.4	11.5	13.9	-	-

NO.	DESCRIPTION	QTY
1	S/STEEL SPRING COIL	1
2	BRASS & S/STEEL SPRAYHEAD HOLDER	1
3	BRASS SECURING SLEEVE	1
4	27.5*24*1.2 PLASTIC WASHER	4
5	20*2 EPDM O-RING	1
6	PLASTIC SLEEVE	1
7	BRASS OUTLET CONNECTOR	1
8	22*2.5 EPDM O-RING	1
9	BRASS SPOUT	1
10	24*2.4 EPDM O-RING	2
11	1/2" CERAMIC DISC VALVE	1
12	PLASTIC SLEEVE	1
13	M4*9 S/STEEL SCREW	1
14	26*24*1.2 PLASTIC WASHER	1
15	BRASS DIVERTER HANDLE BODY	1
16	M4*15 S/STEEL GRUB SCREW	1
17	BRASS DIVERTER HANDLE ROD	1
18	23*16*2 EPDM AERATOR WASHER	1
19	M24*1 PLASTIC AERATOR	1
20	M24*1 BRASS AERATOR CASING	1
21	BRASS OUTLET CONNECTOR PIPE	1
22	23*1.5 EPDM O-RING	1
23	BRASS TAP BODY	1
24	ZINC-ALLOY BASE PLATE	1
25	46x38x2.5 EPDM BASE PLATE WASHER	1
26	48*M32*1.25 TAP FIXING SET	1
27	35MM CERAMIC DISC CARTRIDGE	1
28	BRASS CARTRIDGE NUT	1
29	PLASTIC HANDLE COLLAR	1
30	ZINC-ALLOY HANDLE BODY	1
31	M5*6 S/STEEL HANDLE SCREW	1
32	BRASS HANDLE ROD	1
33	BRASS PROTECTIVE CAP	1
34	15*1*1/2*765 S/STEEL PULL-OUT HOSE	1
35	M6*10*19 BRASS DECORATIVE CAP	1
36	PLASTIC HOLDER SLEEVE	1
37	PRESS ON SPRAY HEAD	1
38	10*1*1/2*500 S/STEEL FLEXITAILS	2

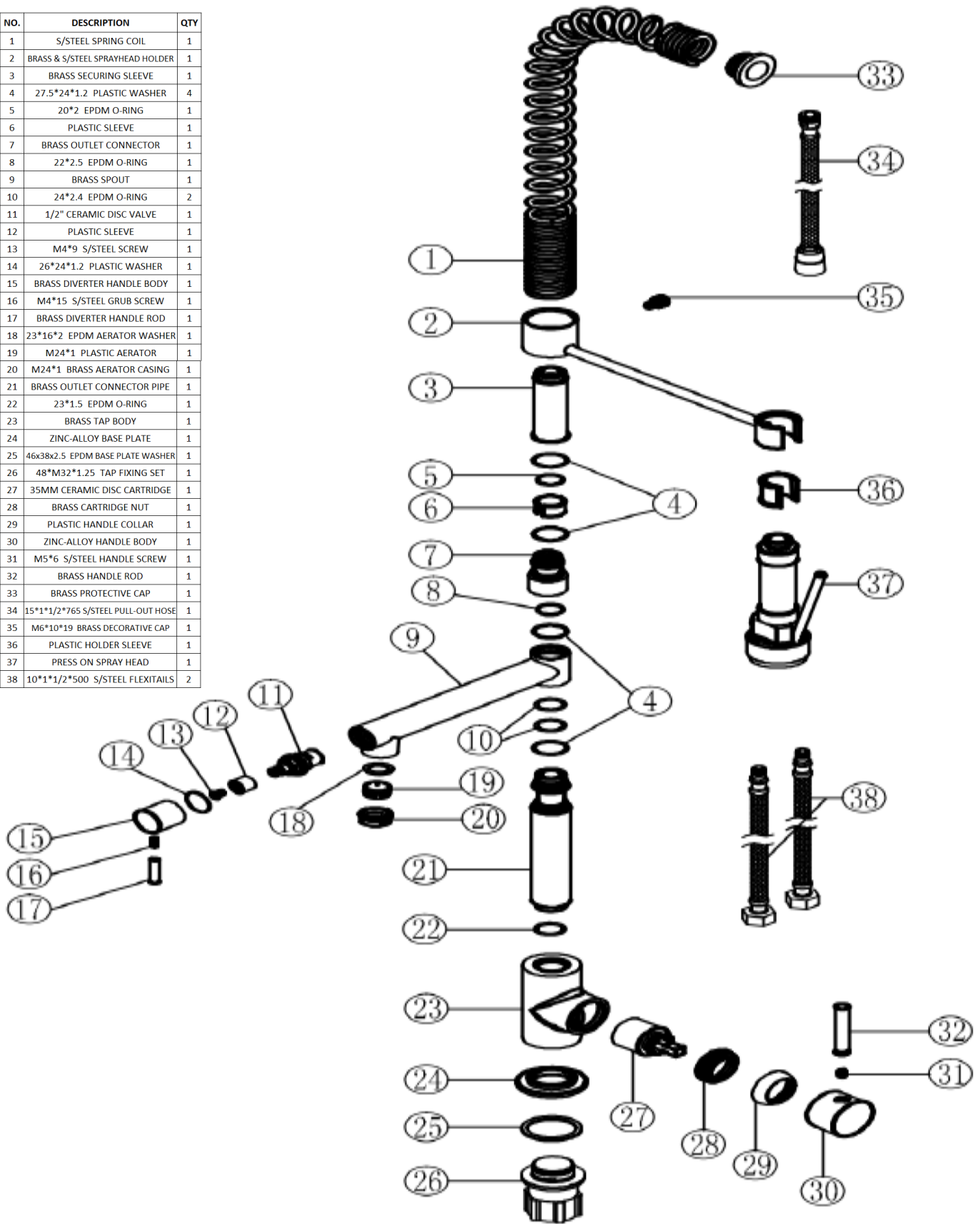

FOR FURTHER ADVICE PLEASE CONTACT :-

SAGITTARIUS LTD UNIT 1 LOWER VICTORIA STREET—CHADDERTON—OLDHAM—OL9 9TU TEL:0616 6202029

EMAIL:TECHNICAL@SAGITTARIUSTAPS.CO.UK