

# SAGITTARIUS

## TAPS & SHOWERING

### TAME CLOAKROOM BASIN MIXER CHROME TA/186/C

<b>Construction</b>	Brass Body (CuZn40Pb2), EN CW617N (equivalent to BS CZ122) Zinc-alloy Handle
<b>Finishes</b>	Chrome plated to BS EN 248
<b>Product Type</b>	Contemporary
<b>Water Pressure Tested Between</b>	Min. 0.5 bar, Max. 6.0 bar
<b>Standards</b>	Complies with BS6920, BS EN200
<b>Cartridge</b>	35mm CITEC Ceramic disc cartridge
<b>Aerator</b>	Male M24x1 NEOPERL Laminar spout aerator
<b>Fitting</b>	UK: M10 x 350mm G½" BSP Female Flexi Tails EU: M10 x 350mm G3/8" BSP Female Flexi Tails
<b>Guarantee</b>	10 years against manufacturing faults (excluding serviceable parts)
<b>Additional Information</b>	Supplied with G 1¼" sprung waste (UK only)

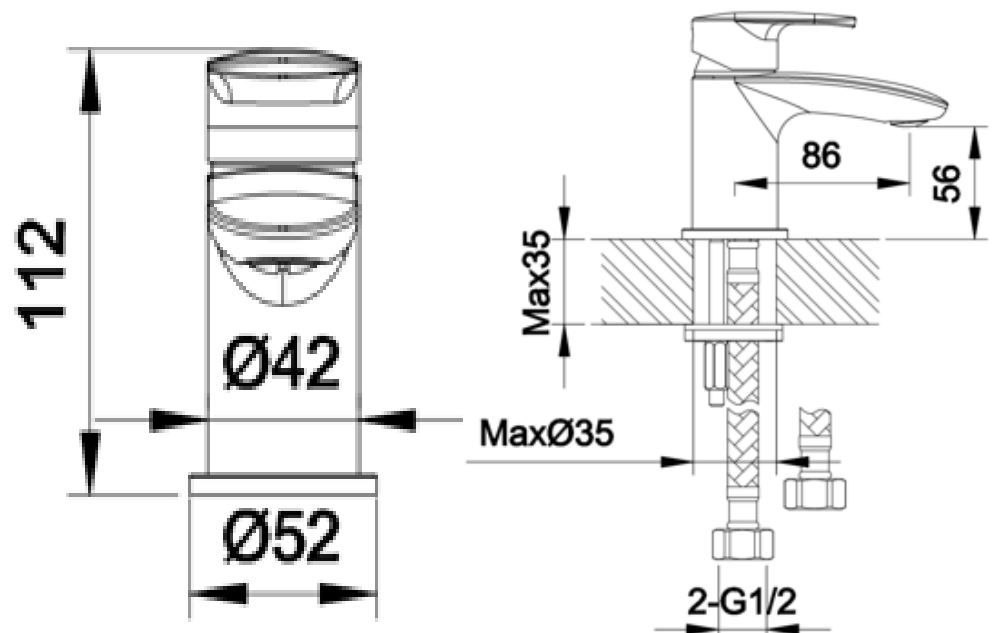

The information contained on this page was correct at the date of issue. Fitting dimensions are provided as a guide only. Some variation may occur due to manufacturing tolerances. We pursue a policy of continuing improvement in design and performance of our products and so reserve the right to change specifications without prior notice

FOR FURTHER ADVICE PLEASE CONTACT :-  
SAGITTARIUS LTD UNIT 1 LOWER VICTORIA STREET—CHADDERTON—OLDHAM—OL9 9TU TEL:0616 6202029  
EMAIL:TECHNICAL@SAGITTARIUSTAPS.CO.UK

**Flow Rates (Litres per minute)**

System Pressure	0.1 Bar	0.2 Bar	0.3 Bar	0.5 Bar	1.0 Bar	1.5 Bar	2.0 Bar	3.0 Bar	4.0 Bar	5.0 Bar
	-	-	-	10.4	12.2	-	16.5	19.8	22.8	-

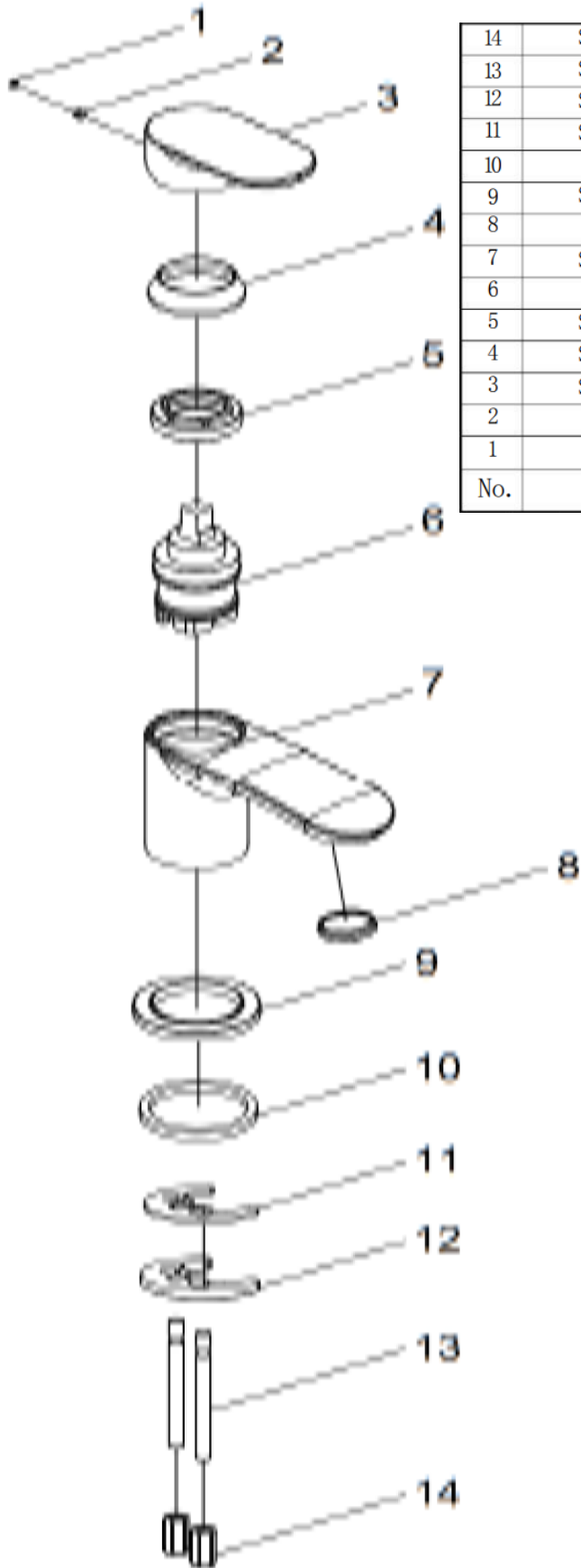

14	S85801000200	M6 fixing nut	HPb57-3	2
13	S85801000300	M6 fixing rod	SUS304	2
12	S85801000400	metal plate	SUS304	1
11	S85801000500	gasket	NBR	1
10		gasket	NBR	1
9	S87301001100	base plate	HPb57-3	1
8	452100.000	aerator	Assembly	1
7	S60301000700	body	HPb59-1	1
6	CT35UH001	35 cartridge	Assembly	1
5	S81915003200	Lock Nut	HPb57-3	1
4	S60301000400	cover cap	ABS	1
3	S60301000300	handle	Zinc alloy	1
2	M010505	M5 grub screw	SUS304	1
1		grub screw cover	ABS	1
No.	Part No.	Item	Material	QTY

FOR FURTHER ADVICE PLEASE CONTACT :-

SAGITTARIUS LTD UNIT 1 LOWER VICTORIA STREET—CHADDERTON—OLDHAM—OL9 9TU TEL:0616 6202029

EMAIL:TECHNICAL@SAGITTARIUSTAPS.CO.UK