



Collection: Layton

Technical specifications

| | |
|-----------------------|-------------------|
| Colour | White |
| Height | 50 |
| Width | 366 |
| Depth | 459 |
| Designer | VitrA Design Team |
| Hinge Material | Metal |
| Hinge Type | Fixed Hinge |

| | |
|--|---------------|
| Installation Detail (TMM KAPAK) | Bottom fixing |
| Packaged Product Sizes (WxDxH) | 502X384X63 |
| Soft close | No |
| Thickness | Standard |
| WC Seat Wrap Type | Sandwich |
| Quick Release | No |
| Certificate | NF |
| Body Material | DP-Duroplast |

| | |
|-------------------------------|--------|
| Design Shape Washbasin | Oval |
| Design Shape Wcandwc | Oval |
| Seatandbidet | |
| Hinge Color | Chrome |
| Guarantee | 2 |

2A technical drawing

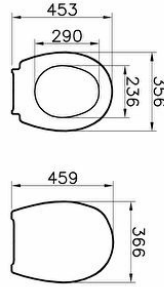
**Technical specifications**

Colour: White **Height:** 50 **Width:** 366 **Depth:** 459 **Designer:** VitrA Design Team **Hinge Material:** Metal **Hinge Type:** Fixed Hinge

Installation Detail (TMM KAPAK): Bottom fixing **Packaged Product Sizes (WxDxH):** 502X384X63 **Soft close:** No **Thickness:**

Standard **WC Seat Wrap Type:** Sandwich **Quick Release:** No **Certificate:** NF **Body Material:** DP-Duroplast **Design Shape**

Washbasin: Oval **Design Shape Wcandwc Seatandbidet:** Oval **Hinge Color:** Chrome **Guarantee:** 2